

K:\2008 Projects\0834 20th & Pettygrove\CONSTRUCTION DOCUMENTS\CONSULTANTS\Plumbing\Permit Drawings - Standard\Plumbing Permit Drawings.dwg\1 P-1 kaman 04/16/10 14:04 s:1

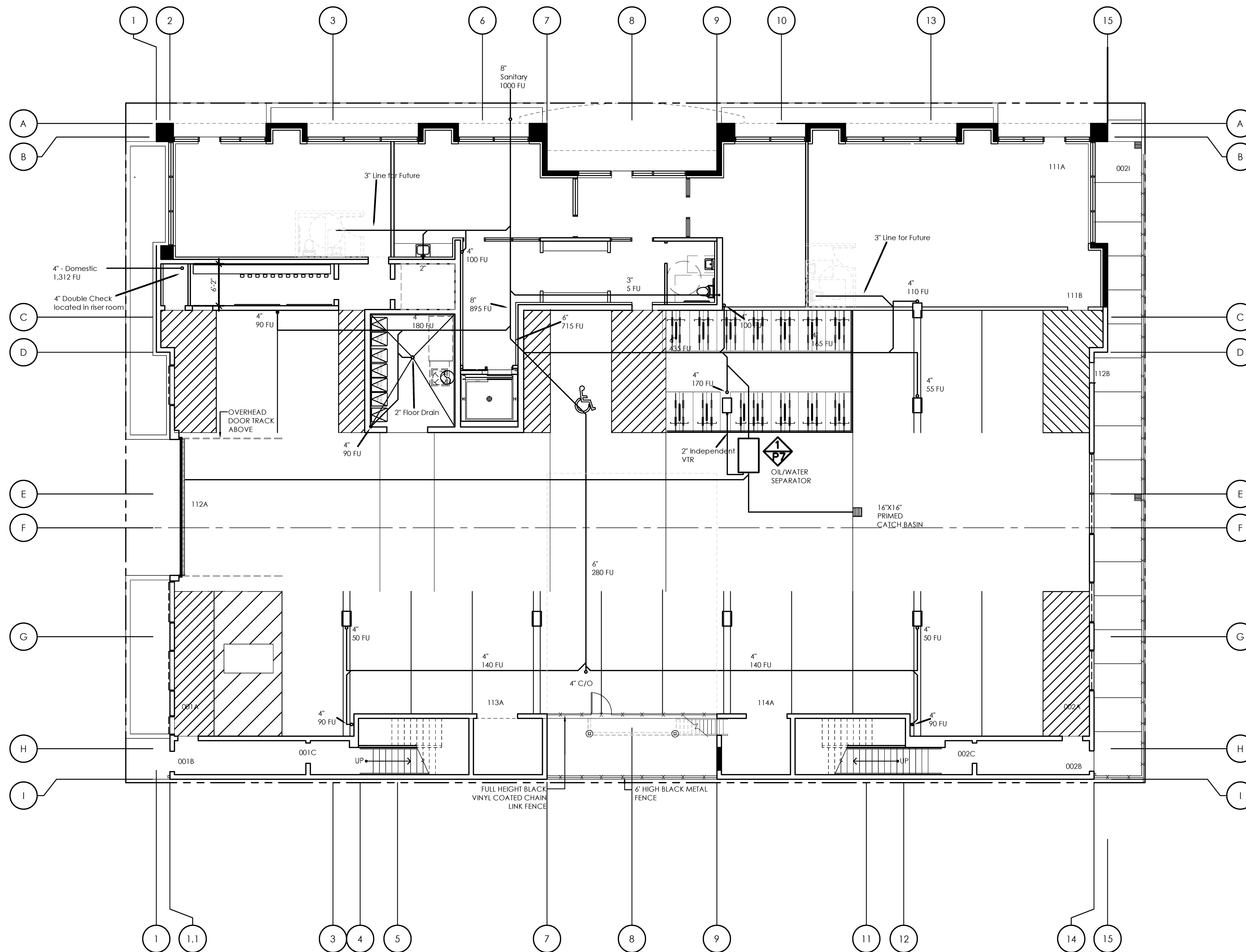

1 FIRST FLOOR UNDERGROUND PLAN
P-1

SCALE: 1/8"=1'-0"

WOLCOTT PLUMBING
1075 West Historic Columbia River Hwy.
Troutdale, Oregon 97060
Phone: (503) 667-1781
Fax: (503) 667-9891

williamwilsonarchitects pc
10250 NE 15TH AVE, SUITE 200
PORTLAND, OREGON 97228
(503) 282-8888 Fax: (503) 272-6025 www.williamwilson.com

20TH & NW PETTYGROVE
1984 NW PETTYGROVE ST
PORTLAND, OREGON 97209
PHASE TWO DEVELOPMENT
131 NORTH STATE STREET, SUITE G
LAKE OSWEGO, OR 97034

FIRST FLOOR
UNDERGROUND
PLAN

REVISIONS:

△	01/28/10 - COP
△	03/01/10 - COP
△	03/30/10 - COP

DATE: 12/28/09
SCALE:
DRAWN:
JOB NO: 0834

P-1